



# **Installation Instructions**

Soundbooster Pro

Maserati Levante

Maserati Quattroporte Diesel

Maserati Ghibli Diesel

Maserati Ghibli Diesel from model year 2016 and afterwards

v1.7 (29.05.2017)

## Contents

1	Liability Exclusion	3
2	Copy Right	4
3	General Notes	4
4	Safety instructions	5
5	Requirements for the determinable operation	5
6	Note	5
7	How to connect a cable to another	6
8	Note Cable Inscription/Color	7
9	Assembly Instructions	8
10	Removing trim panel Maserati Quattroporte / Ghibli from model year 2016 forward	9
11	Removing trim panel Maserati Ghibli up to model year 2016	10
12	Removing trim panel Maserati Levante	11
13	Connection CAN High/CAN Low, ground and power supply	13
14	Connection and placing module	14
15	Notes for use	15
16	Notes for additional use Maserati Levante	16
17	Important Information Sound Booster	17

# 1 Liability Exclusion

Dear Customer

Our cable sets are developed according to the connection- and circuit diagrams of the corresponding car manufacturer. Before the original production the cable sets will be tested on an original car. Therefore, the integration into the car electronics will be executed according to the instructions of the manufacturer. Regarding the necessary pre-understanding and the accuracy of the presentation of texts and pictures our mounting guidelines correspond to the usual ones in car technology and car electronics. Practically, they have been proved one's worth a hundred times.

However, should there be any difficulties during the installation of our products we will be at your disposal any time for support by phone or by mail. Moreover, we offer you to execute the installation at our works in Bad Segeberg.

Costs which may arise because a third person will execute the installation of our products will not be supported by us in any case. Only if there is a mistake caused by our product we will pay the proved costs of the installation as well as the costs of the removal of the defective product. The refund of expenses will be limited to gross EUR 110,- ; we reserve the right to check the described mistake in our works in Bad Segeberg. In case of a proved reclamation the costs for dispatch for the check in our factory will be transferred to you.

According to our experience each specific factory which has the necessary diagnostic device, diagnostic software and the circuit diagrams of the manufacturer can find possible mistakes at our products within a short time. So the installation and removal including diagnostic inspection can be realised in at most 60 minutes.

We also made the experience that many specific factories cannot work with the circuit diagrams of the manufacturer, and that they cannot read usual wiring diagrams. Therefore, very easy installation works will take many hours. You will understand that we neither take the risk to find a reliable specific factory nor the financing of the training of the staff of your favoured factory.

Costs which will arise because you buy missing parts or spare parts at other suppliers will be refunded by us up to the amount of the costs which had been arisen by additional supply (saved expenses). In this case, there would be no right for refund according to the legal guarantee right as long as we have no deadline for supplementary performance or a deadline for supplementary performance has not expired.

So if you have any problems with the installation or operation of one of our products please call us, send us an email, send us the product or take your car to our factory in Bad Segeberg. We are sure to find an appropriate solution for each concern.

With best regards

Your Kufatec GmbH & Co. KG Team

## 2 Copy Right

Our installation- and removal instructions, installation plans, software and other documentation with texts or pictures are protected by copy right.

A publication or distribution of these documents is only permitted with a written approval of Kufatec GmbH & Co. KG.

## 3 General Notes

Regarding the development there has especially been paid attention to your personal safety together with the most possible operating comfort, modern design and actual product technologies.

Despite most possible accuracy in case of incorrect installation or use or in case of incorrect operating, it is possible that injuries or damages of property may arise.

Therefore, please read the operating instructions you have received carefully and completely, and keep it with you.

All articles of our production will be checked at 100% — for your safety.

We reserve the right to make technical changes which serve the progress at any time.

Before the installation or startup it may be necessary, depending on the article and purpose of use, to check the legal instructions of each country.

In case of warranty claim the device has to be sent to the seller originally packed together with the sales receipt and a detailed description of the mistake. Please consider the manufacturer's instructions for return (RMA). The legal warranty instructions are valid.

The warranty claim and also the permission for startup will expire in case of:

- unauthorised changes on the device or the accessories which have not been executed or approved by the manufacturer or its partners
- opening of the box
- repair of the device on your own
- incorrect use / no normal use / startup
- influence of force on the device (falling down, wilful damage, accident, etc.)

During the installation please consider all safety and legal instructions. The device may only be installed by trained qualified personnel or persons who are similar qualified.

**In case of installation- or function problems please reduce the search of the mistake to approx. 0,5 hours for mechanical works or 1,0 hours for electronic works.**

To avoid unnecessary additional work and expenses, please send immediately an inquiry to our technical support with the Kufatec contact form (<http://www.kufatec.de/shop/de/infocenter/>)

Please absolutely mention the following:

- car chassis number
- part number of the add-on kit
- exact description of the problem
- work steps already made

## 4 Safety instructions

The installation may only be executed by trained qualified personnel. Please execute the installations only in a condition of dead voltage. Here please separate for example the battery from the main power supply and consider the instructions of the car manufacturer.

- In order to not endanger your own driving safety please never use security relevant screws, bolts or other fixation pieces at steering, brake system or other components.
- Connect the device only at 12V wiring system voltage with ground connection to the autobody. This assembly is not allowed for the use in trucks or other cars with 24V wiring system voltage.
- Please avoid the installation of the device at positions where the driving safety or the functional efficiency of other subassembly integrated in the car are restricted.
- This module may only be used together with the following mentioned car types and models; the installation may be executed exclusively by use of the circuit points mentioned in the assembly instructions.
- Kufatec GmbH & Co. KG does not assume liability for damages which are caused by incorrect installation, the use of inapplicable circuit points or the installation into car types and -modules which are not foreseen.
- We would like to draw your attention to the fact that the module processes the data of the MOST-protocol of the car mentioned below. Therefore, during the installation of the module it will be used a model-specific complete system which we as the manufacturer of the mentioned construction line only know partly.
- Especially in case of changes within the same model line and the same year we therefore cannot guarantee the applicability of our construction line in each case. Kufatec GmbH & Co. KG does not assume liability for the applicability of our construction line with changes made by the manufacturer.
- Kufatec GmbH & Co. KG does not assume liability that the installation of the here described component has been permitted according to the guarantee instructions of particular car manufacturers. Therefore, please consider the guidelines for installation and guarantee conditions of your car manufacturer before installation.
- The manufacturer reserves the right to change components without giving reasons.
- Subject to errors and changes

## 5 Requirements for the determinable operation

Please use the device only in its the corresponding area.

In case of unprofessional and untypical use, installation or modification the permission for operation and the warranty claim will expire.

## 6 Note

**Make sure that there's enough space at the described position. If there is no space please cancel the installation and contact our technical support.**

**The use of a sound booster is not permitted without registration in the vehicle papers, in the area of the german StVZO. The noise emission of the vehicle is increased by this retrofit. The regulations of the StVZO must be observed. It is therefore recommended to ask for a specific registration option at the responsible TÜV/DEKRA office before retrofitting. Outside Germany, please observe the laws on vehicle licensing applicable in your country.**

## 7 How to connect a cable to another

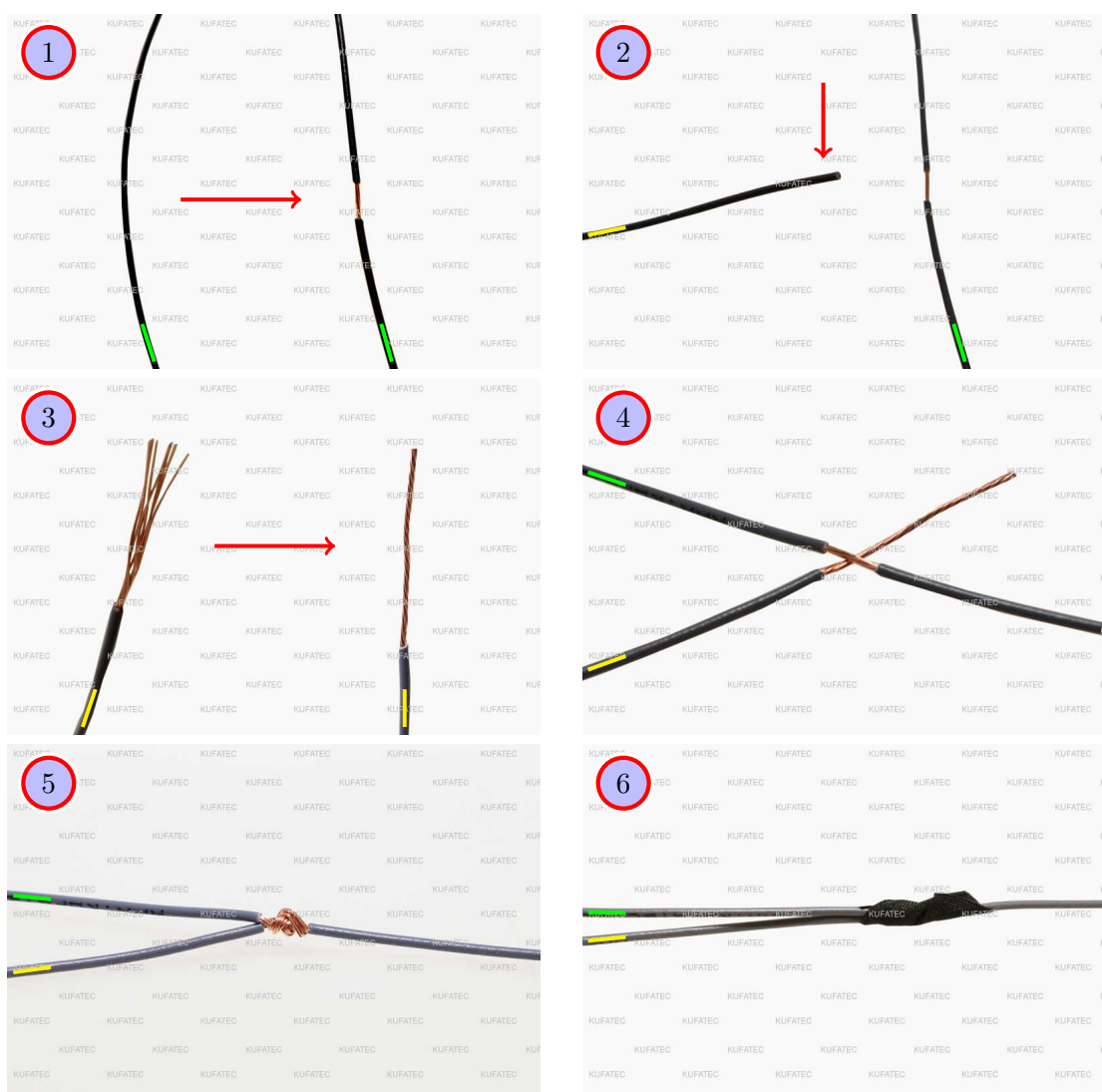

Figure 1: How to connect a cable to another

Table 1: How to connect a cable to another

No.	Work step	Note
1	Take the cable of the vehicle, to which you want to connect, (green marked here) and strip the insulation at one point with a suitable tool (cable stripper/cutter knife).	
2	Now take the cable of the cable set, which you want to connect, (yellow marked here) and strip the insulation at the end.	
3	Twirl the wires of the stripped cable together.	
4	Place the end of the cable you want to connect under the stripped point of the cable of the vehicle...	
5	... and wrap the cable you want to connect around the cable of the vehicle.	
6	Lastly, stick insulating tape around the connection point.	

## 8 Note Cable Inscription/Color



Figure 2: Cable Inscription

**If our cable set consists exclusively of grey wires, connect the wires according to the cable inscription.**

## 9 Assembly Instructions

The following illustration shows the position of the individual components.

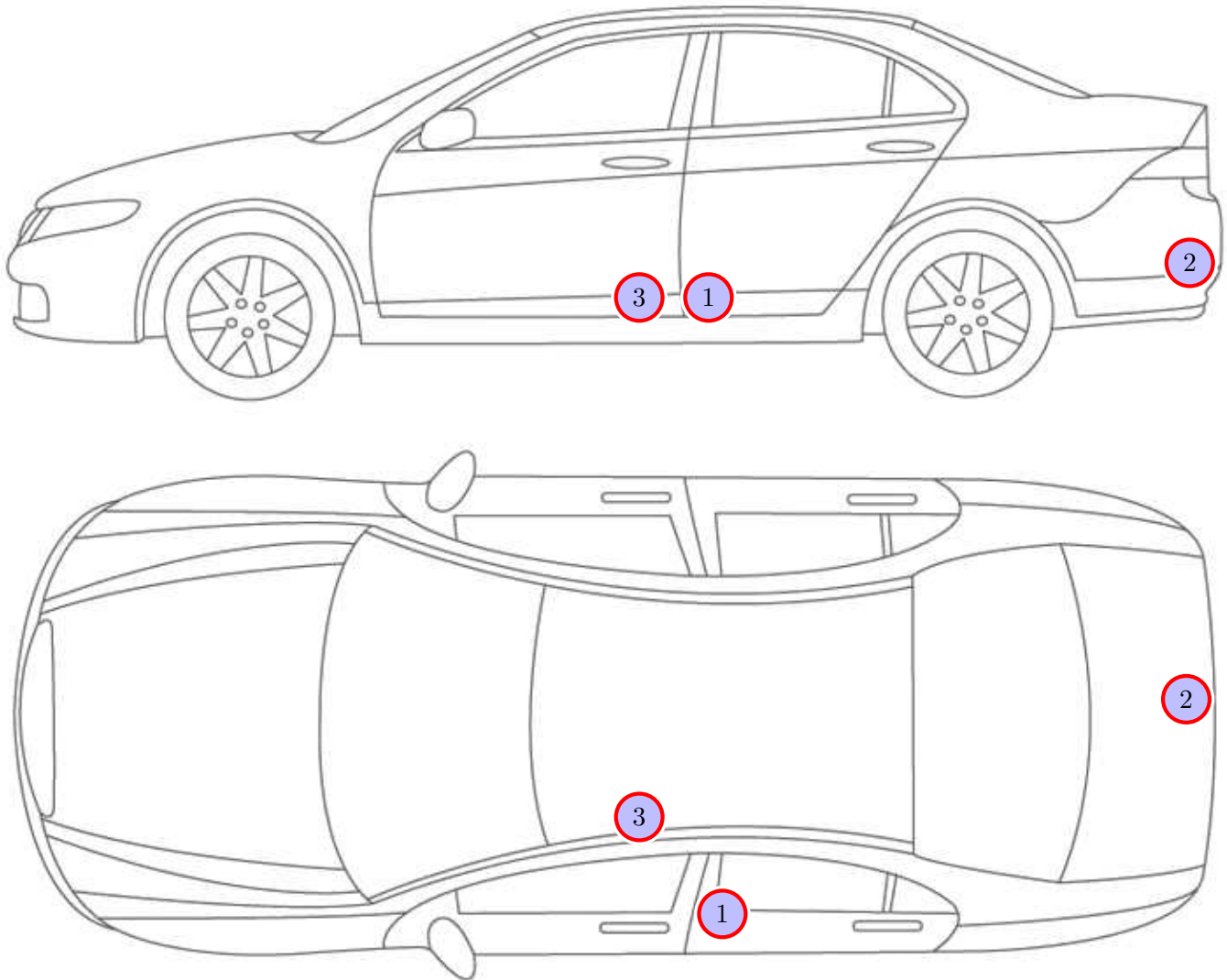

Figure 3: Vehicle overview

- 1 Soundbooster Pro module Quattroporte Diesel / Ghilbli Diesel from model year 2016 forward
- 2 Soundbooster Pro module Ghilbli Diesel up to model year 2016
- 3 Soundbooster Pro module Levante



## 10 Removing trim panel Maserati Quattroporte / Ghilbli from model year 2016 forward



Figure 4: Removing trim panel Quattroporte / Ghilbli from model year 2016 forward - pictures

Table 2: Removing trim panel (under the driver's seat) - instructions

No.	Work step	Note
1	Push the driver's seat quite forward to reach the trim panel of the air vent under the driver's seat.	
2	Remove the trim panel of the air vent by pushing it slightly to the right and pulling it out from behind.	
3	The control unit is located beneath, move the plug from the control unit off by loosening the rose-coloured interlock.	
4	Open the plug by removing the cap of the plug carefully.	
4.1	To remove the cap of the plug press the open end together carefully.	
5	Please connect the module as described on page 13.	

## 11 Removing trim panel Maserati Ghibli up to model year 2016

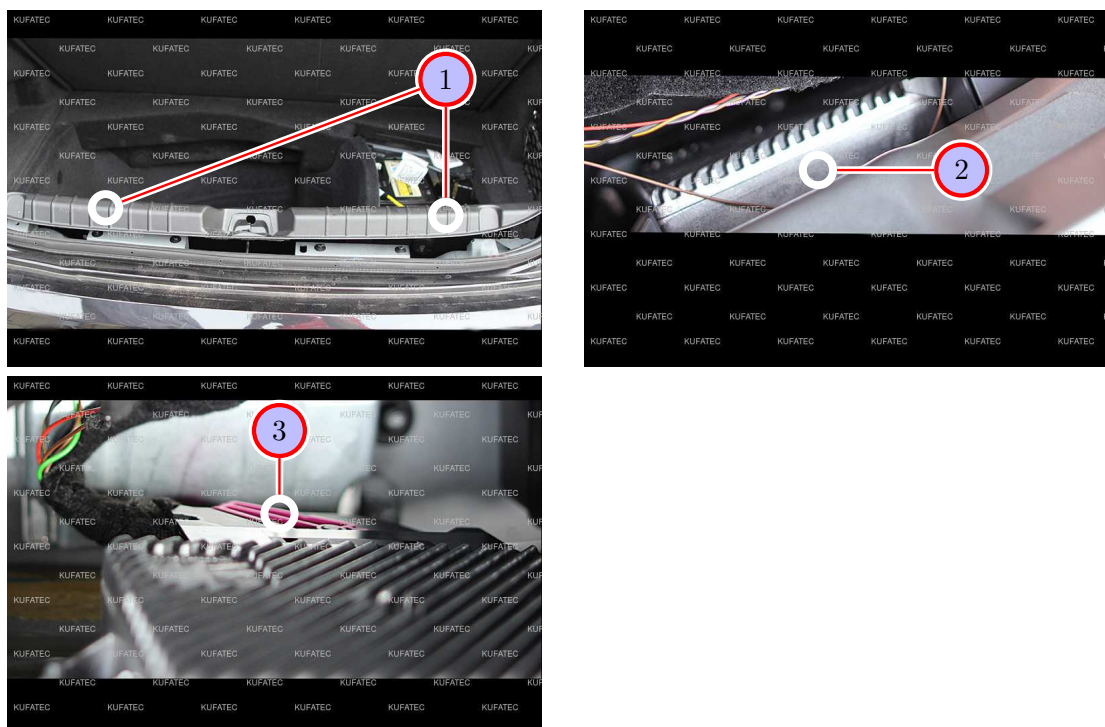

Figure 5: Removing trim panel Ghibli up to model year 2016 - pictures

Table 3: Removing trim panel (trunk) - instructions

No.	Work step	Note
1	Remove the trim panel above the tail end cover plate. In doing this, be extremely carefully, because the interlock clips break very easily.	
2	Afterwards remove the carpet cover, so that you reach the control unit.	
3	Move the plug from the control unit off, for this loosen the rose-coloured interlock.	
	Open the plug by removing the cap of the plug carefully. To remove the cap of the plug, press the open end together carefully.	
4	Please connect the module as described on page 13.	

## 12 Removing trim panel Maserati Levante

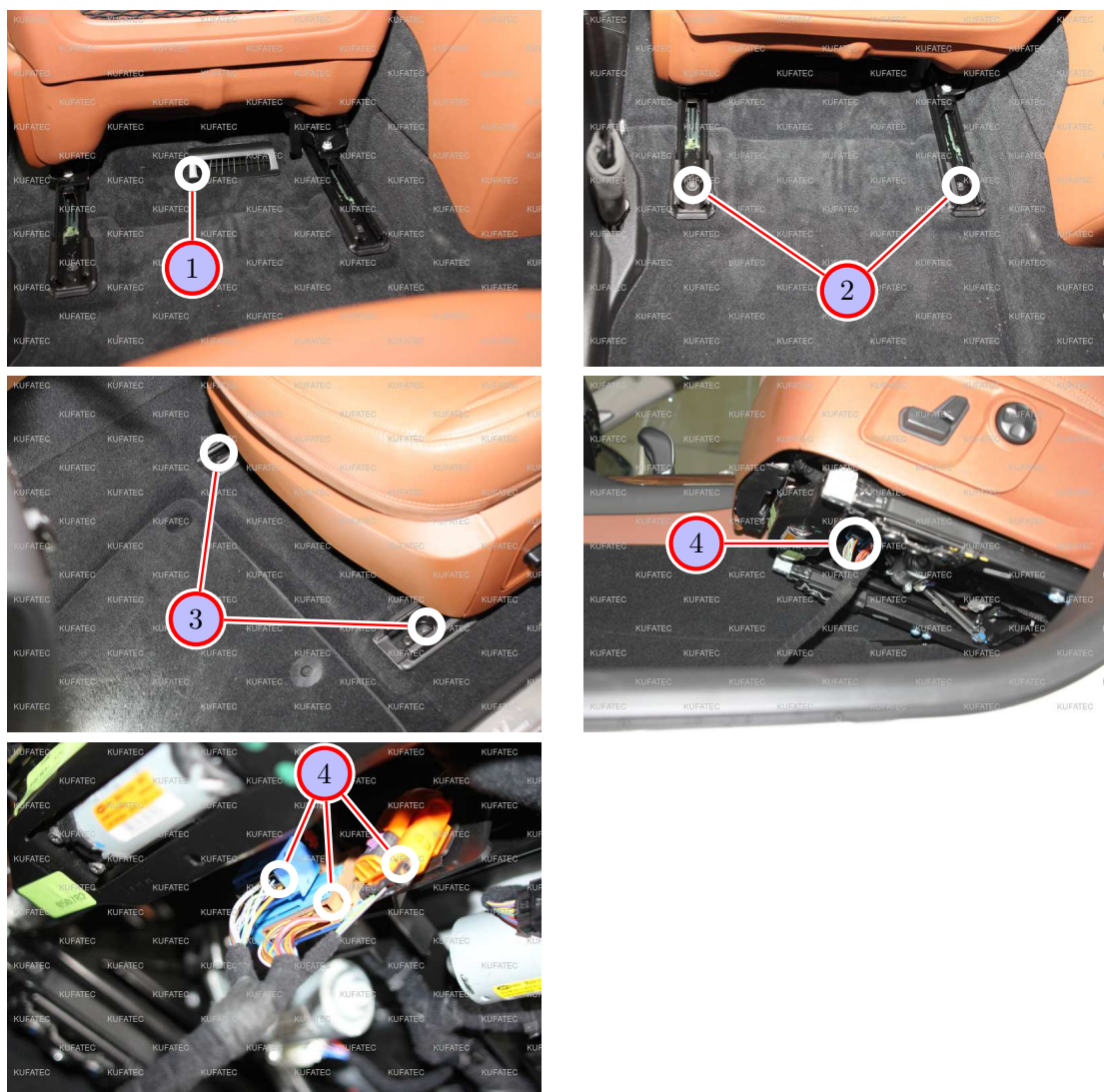

Figure 6: Removing trim panel Maserati Levante - pictures

Table 4: Removing trim panel - instructions

No.	Work step	Note
1	Remove the ventilation grille by loosening the snap-fits on the right and on the left with a trim tool and then moving it off carefully.	
2	Loosen the marked screws of the guide rails of the driver's seat behind.	2xE12
3	Now loosen the front screws of the guide rails of the driver's seat.	2xE12
4	Tilt the driver's seat rearwards carefully and remove the marked plugs of the driver's seat. Afterwards it can be pulled a bit rearwards. Doing this, pay attention that the stay bolts in the back at the guide rails don't damage the carpet.	



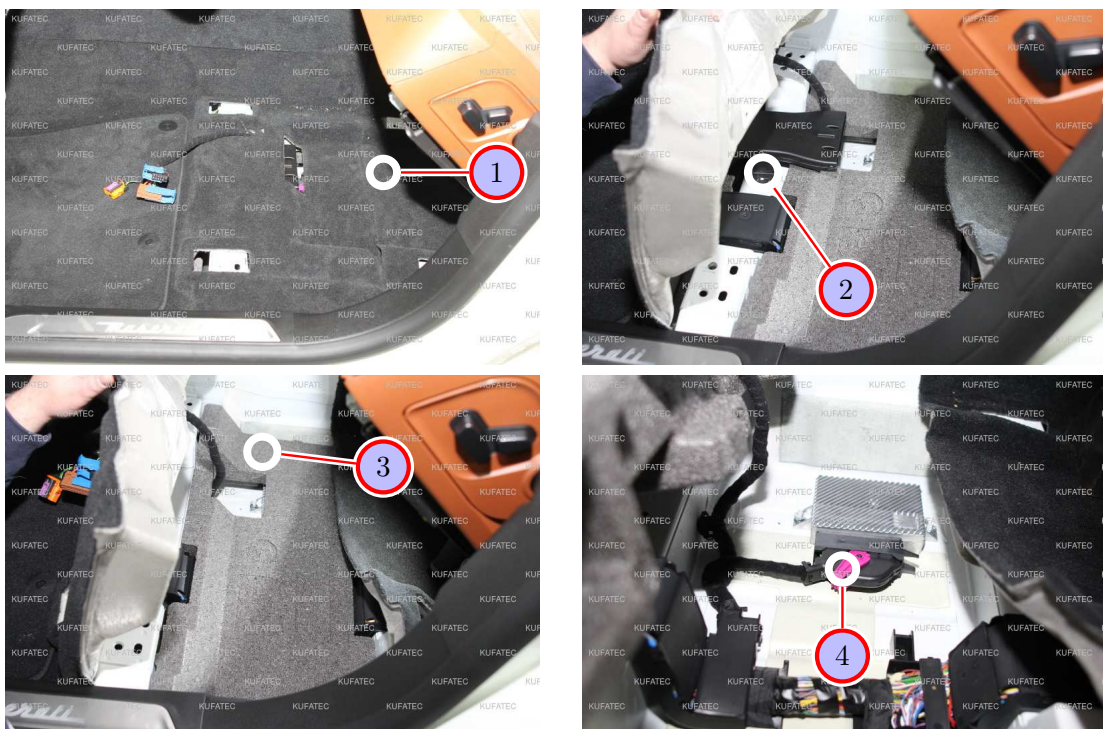

Figure 7: Removing trim panel Maserati Levante - pictures

Table 5: Removing trim panel - instructions

No.	Work step	Note
1	Pull the carpet up and fold it in the direction of the dashboard carefully afterwards.	
2	Loosen the marked air duct by pulling it up first and taking it out rearwards afterwards.	
3	Now take the marked polystyrene covering out and uncover the control unit.	
4	Remove the plug from the control unit by loosening the rose interlock. Afterwards make the connection as described on page 13.	

## 13 Connection CAN High/CAN Low, ground and power supply

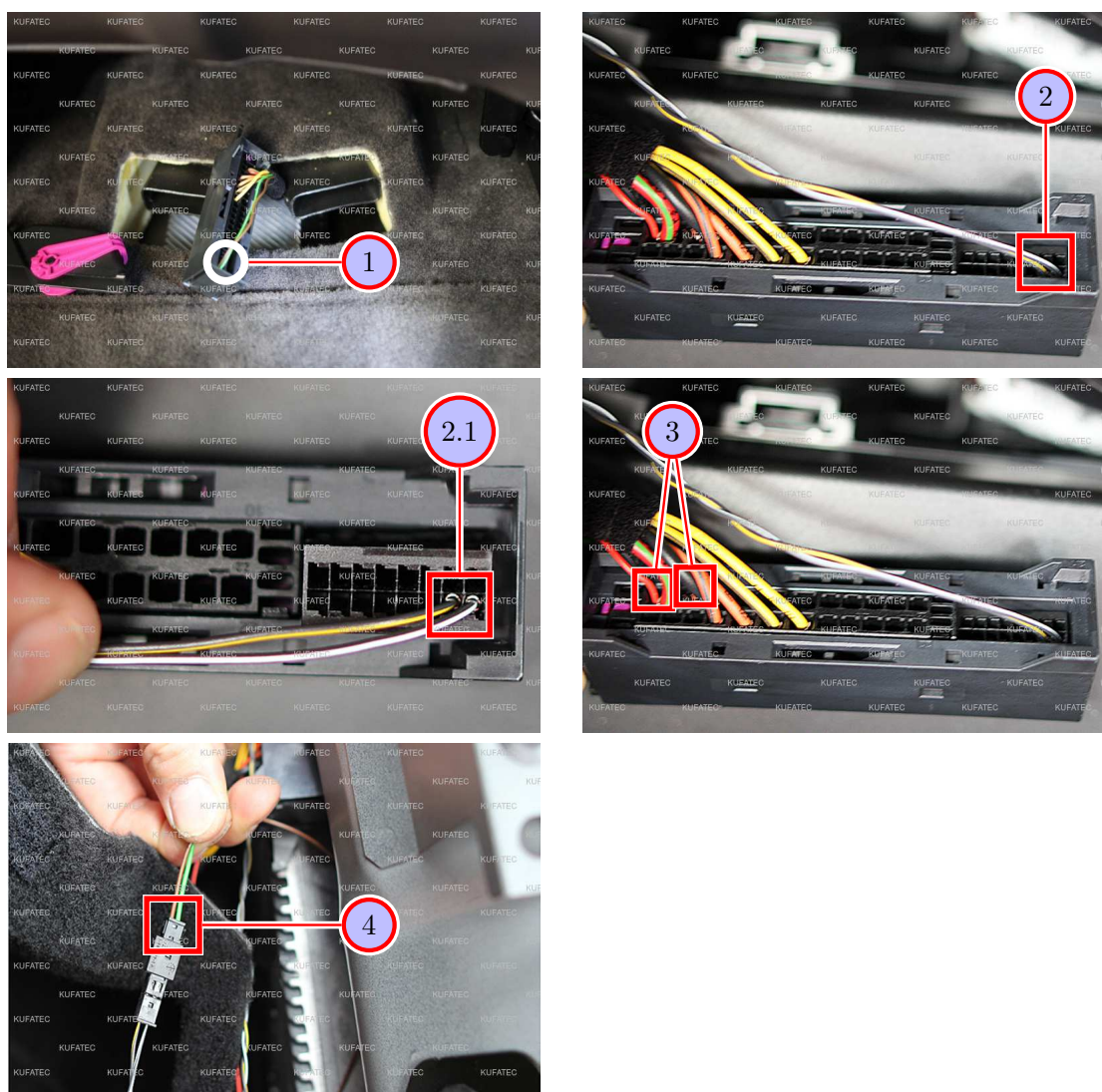

Figure 8: Connection CAN High/CAN Low, ground and power supply - pictures

Table 6: Connection CAN High/CAN Low, ground and power supply - instructions

No.	Work step	Note
1	Remove the green and the brown cable with the pins out of the plug.	
2	Place CAN High and CAN Low there as follows:	
	Place CAN High (black/white) in the front contact bank, in the outer right pin.	PIN 38
	Place CAN Low (black/yellow) left aside.	PIN 37
2.1	Top view connection CAN High and CAN Low.	
3	Connect the cable (red/white - inscription: <b>plus</b> ) for the power supply also to the red/green cable of the plug (PIN 1). Connect the brown ground cable (inscription: <b>ground</b> ) also to the black cable of the plug (PIN 2). How to connect one cable to one other you can see at page 6.	
4	Place the removed cables green and brown in the delivered 2-pole plug housing. PIN assignment: brown in PIN 1, green in PIN 2. Connect the plug with the connector of the cable set. Check the PIN assignment. The brown cable (PIN 1) has to be connected with CAN Low (black/yellow - inscription: 1), and the green cable has to be connected with CAN High (black/white - inscription: 2).	
5	If our cable set consists exclusively of grey wires, connect the wires according to the wire's inscription at the end of the wires.	

## 14 Connection and placing module

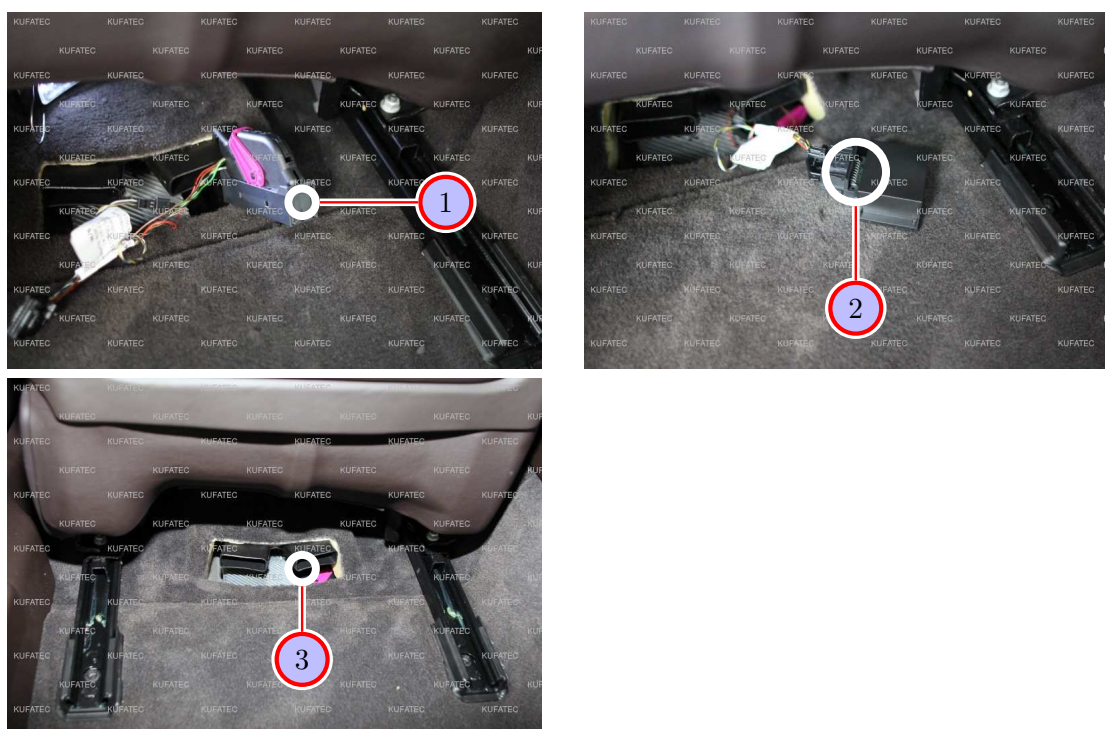

Figure 9: Connection and placing module - pictures

Table 7: Connection and placing module - instructions

No.	Work step	Note
1	Plug the reassembled plug in the control unit.	
2	Connect the Soundbooster Pro module also to the wiring harness.	
3	Depending on which Maserati model you have: - Quattroporte and Levante: Place the Soundbooster Pro module under the driver's seat in the tray, where also the control unit is located. - Ghibli: Attach the Soundbooster Pro module on the trunk floor with suitable mounting material. If you don't want to use the Soundbooster Pro module, remove the module and use the delivered strapping plug.	



## 15 Notes for use



Figure 10: Notes for use - pictures

Table 8: Instructions for use

No.	Work step	Note
1	Note for use: The Sound Booster is controlled by the sport button in the center console. Sport off - activates sound profile 1. Sport on - activates sound profile 2.	
2	When cruise control and limiter are deactivated, you can adapt the volume in both sound profiles by using the marked rocker switch of the cruise control at the steering wheel.	
	By pushing the rocker switch up the volume turns up.	
	By pushing the rocker switch down the volume turns down.	
	The change of the volume will be automatically saved in the profile which is active.	
	The firmware (software) needs to be at least version 2.77. You can find the current firmware on our website <a href="http://www.sound-booster.com">www.sound-booster.com</a> .	
3	<b>Important:</b> For vehicles with ACC (Adaptive Cruise Control) the adjustment of the volume is only possible if all vehicle doors are closed.	

## 16 Notes for additional use Maserati Levante

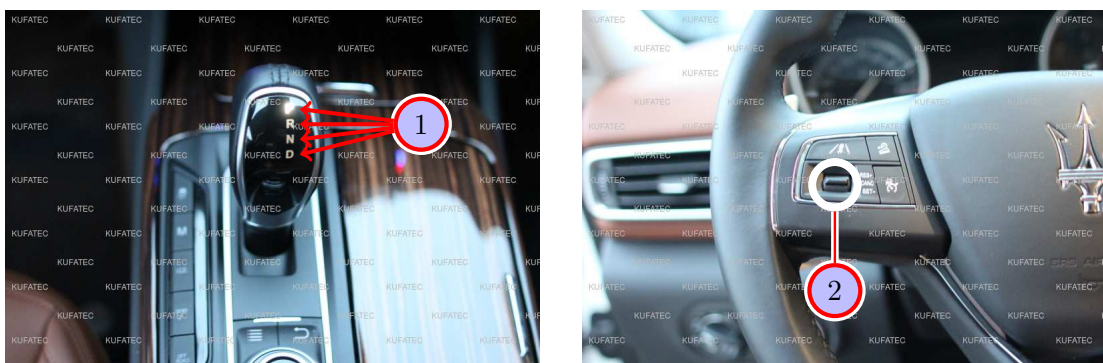

Figure 11: Notes for additional use Maserati Levante - pictures

Table 9: Instructions for use

No.	Work step	Note
1	In the Maserati Levante, the volume is different depending in which position you are. In the two positions <b>P</b> & <b>N</b> the volume is increased. As soon as you shift in the positions <b>R</b> or <b>D</b> , the volume decreases automatically.	
2	To increase the volume in the position <b>R</b> or <b>D</b> , press and hold the marked rocker switch for the cruise control for about 1,5 seconds. It's important for this that the limiter and the cruise control are deactivated.	
3	The control, as described on page 15, can also be used additionally in the Maserati Levante.	



## 17 Important Information Sound Booster

Please use for the fixation of the Sound Booster suitable high tensile screws. In order to avoid loosening of the screws by vibration please make the screws safe with appropriate factory material e.g. Threadlock. Please additionally check the stability of the Sound Booster regularly and if necessary retighten the screws. In case of no consideration we do not assume liability for possible damages. After successful installation we recommend to cover the sound generator with a zinc spray. Make sure that you cover the opening of the sound generator so that no zinc spray can't get inside the sound generator.

As additional safety the delivered steel cable and the retaining clips have to be tightened on the Sound Booster as well as at a suitable position in the car. This safety cable is an additional security should the tightening screws should be released by vibration.

## List of Figures

1	How to connect a cable to another . . . . .	6
2	Cable Inscription . . . . .	7
3	Vehicle overview . . . . .	8
4	Removing trim panel Quattroporte / Ghibli from model year 2016 forward - pictures . . . . .	9
5	Removing trim panel Ghibli up to model year 2016 - pictures . . . . .	10
6	Removing trim panel Maserati Levante - pictures . . . . .	11
7	Removing trim panel Maserati Levante - pictures . . . . .	12
8	Connection CAN High/CAN Low, ground and power supply - pictures . . . . .	13
9	Connection and placing module - pictures . . . . .	14
10	Notes for use - pictures . . . . .	15
11	Notes for additional use Maserati Levante - pictures . . . . .	16

## List of Tables

1	How to connect a cable to another . . . . .	6
2	Removing trim panel (under the driver's seat) - instructions . . . . .	9
3	Removing trim panel (trunk) - instructions . . . . .	10
4	Removing trim panel - instructions . . . . .	11
5	Removing trim panel - instructions . . . . .	12
6	Connection CAN High/CAN Low, ground and power supply - instructions . . . . .	13
7	Connection and placing module - instructions . . . . .	14
8	Instructions for use . . . . .	15
9	Instructions for use . . . . .	16